

COMMON MODE CHOKE (Flat Wire Winding)



- Core Size : SQ1918
- Rated Current : 1.5~ 2.5A
- Dielectric strength : 2000Vrms
- Rated Voltage 250V AC
- Operating Temperature : -20~120°C
- Application : large current & small size power supply

ELECTRICAL SPECIFICATIONS @25°C

Model No.	I RMS (Amps)	OCL(mH min)	MAX DCR(mΩ)	Inductance Difference(uH max)
SQ1918V243	1.0	24	460	200
SQ1918V203	1.5	20	230	200
SQ1918V133	2.5	13	150	200
SQ1918H243	1.0	24	460	200
SQ1918H203	1.5	20	230	200
SQ1918H133	2.5	13	150	200

- * For RoHS compliant products, a.)The Ordering Code: TG-Model No. ex. TG-SQ1918V243
b.) Solder : Sn/Cu; c.)Date Code suffix to "G"
- * Inductance test at 1KHz, 0.25V.



DIMENSIONS & SCHEMATICS

V : Vertical type

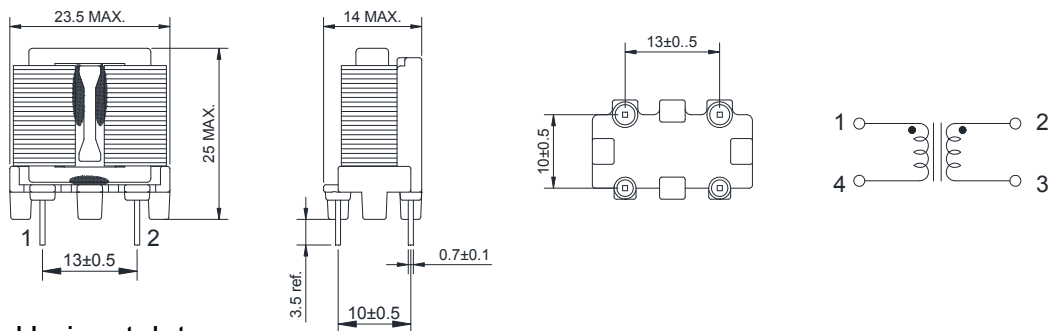

H : Horizontal type

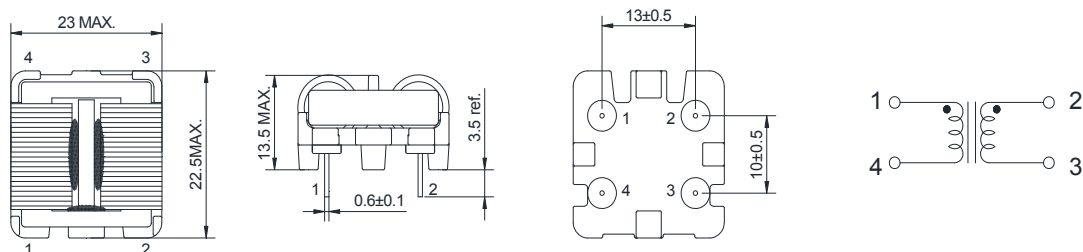

UNIT : mm

*Specifications are subject to change without prior notice.

DATA SHEET 09-34 Jun./18
6 OF 9



UNIVERSAL MICROELECTRONICS CO.,LTD.
TEL:886-4-23590096 FAX:886-4-23590129

3,27TH RD.,TAICHUNG INDUSTRIAL PARK,
TAICHUNG,TAIWAN,R.O.C

COMMON MODE CHOKE (Flat Wire Winding)

Attenuation (typical values at $Z=50\Omega$)

———— asymmetrical, all branches in parallel (common mode)

- - - - - symmetrical (differential mode)

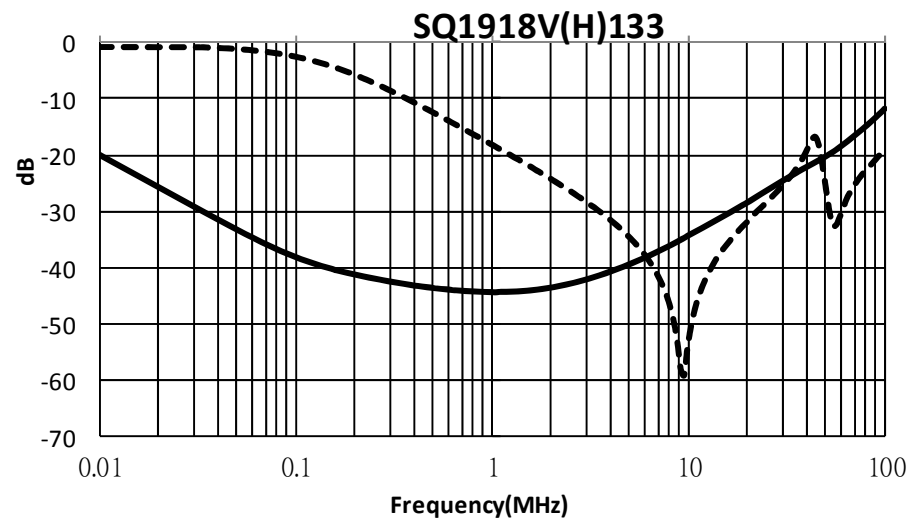
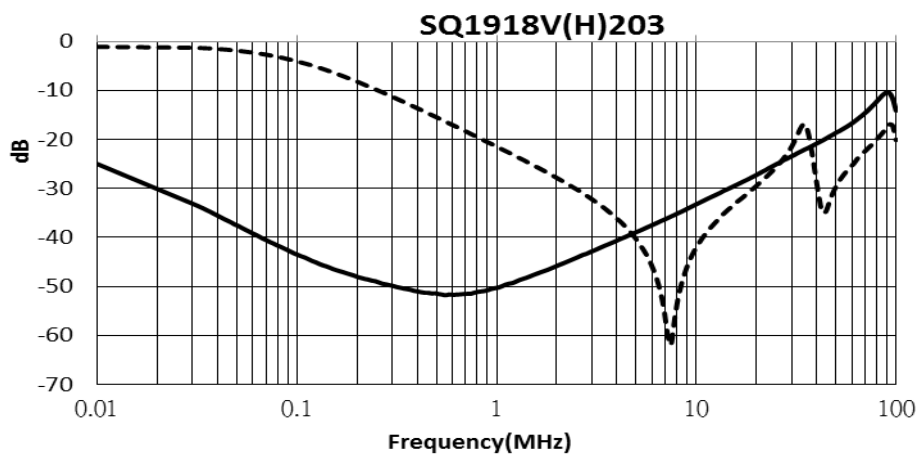
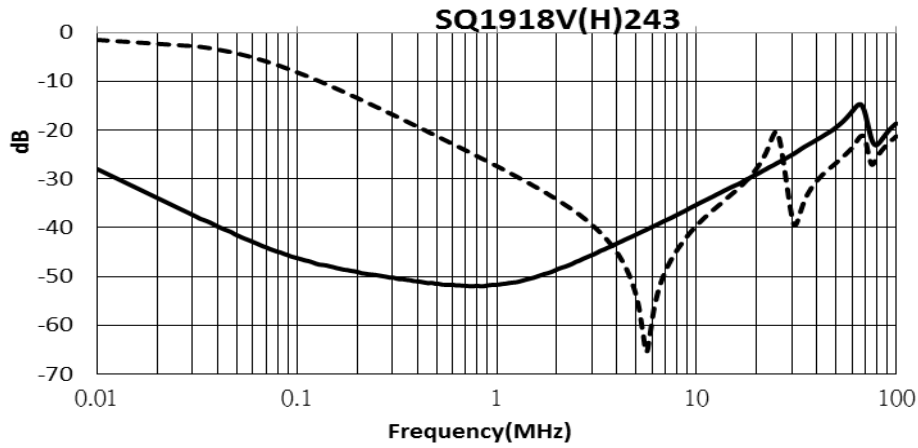

DATA SHEET 09-34 Jun./18
7 OF 9



UNIVERSAL MICROELECTRONICS CO.,LTD.
TEL:886-4-23590096 FAX:886-4-23590129

3,27TH RD.,TAICHUNG INDUSTRIAL PARK,
TAICHUNG,TAIWAN,R.O.C